



Placeable either horizontally or vertically,

2-Way^{plus} bench-top Smoke Absorber



• Vertical installation

HAKKO **PFA-400** **ESD SAFE**
SMOKE ABSORBER



• Horizontal installation



Plus



Option

• Another installation with Arm Stand

The principal components of soldering solvent (flux) are rosin and resin, and they release noxious components when heated and evaporated by soldering work. Prolonged breathing of these contaminants can lead headache, dizziness or eye trouble. The FA-400 is an essential unit to create safe and comfortable working environment protecting operators from direct breathing of unpleasant fume.

Smoke absorber available to use in 2 ways, "normal" and "face-down" position

In addition to horizontal and vertical installations, an optional arm stand allows use in suspended.



Vertical installation

Wide-angle smoke absorption.



Horizontal installation

Powerful absorption at closer area with high flow rate. Because of low height, it gives less shade keeping your working area light.

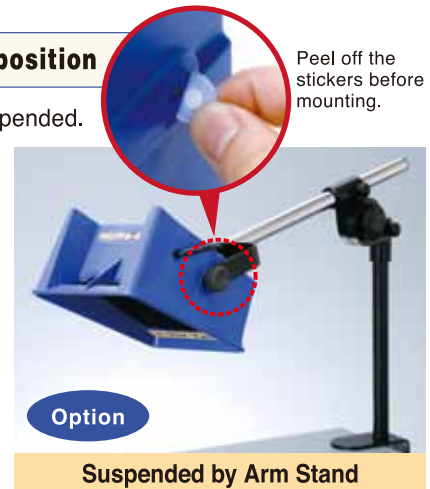

Option

Suspended by Arm Stand

Convenient for approach from above or use in a limited space.

*Arm stand is an optional part.

*The screw holes on FA-400 are covered by stickers.

Peel off the stickers before mounting the absorber in the arm stand.

Space-saving compact design

The footprint was reduced by approx.50% when placed vertically and approx.20% when placed horizontally compared to our former model, the HAKKO 493.

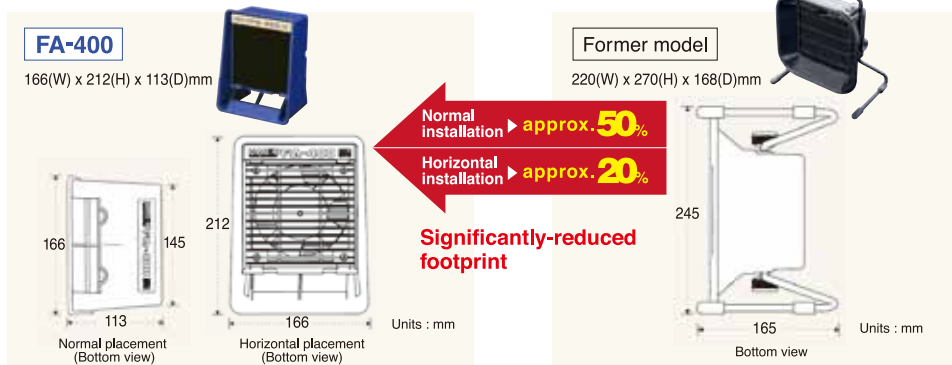

Easy filter replacement



ESD safe by design

Because of ESD safe in design, the FA-400 can be used in the working area where static-sensitive components are processed.

Specifications

● HAKKO FA-400

Model name	HAKKO FA-400				
Power consumption	50Hz	15 W(100 v)	18 W(110 v)	19 W(220 v)	22 W(230 v)
	60Hz	13 W(100 v)	15 W(110 v)	16 W(220 v)	18 W(230 v)
Maximum suction capacity*	Vertically	1.0 m ³ /min.(50 Hz) 1.1 m ³ /min.(60 Hz)			
	Horizontally	0.4 m ³ /min.(50 Hz) 0.5 m ³ /min.(60 Hz)			
Air velocity	Vertically	1.0 m/s(50 Hz) 1.1 m/s(60 Hz)			
	Horizontally	2.6 m/s(50 Hz) 2.9 m/s(60 Hz)			
Dimensions	166(W) x 212(H) x 113(D) mm				
Weight	0.91 kg				
Accessory	Filter (1 pc)				

*Measured with a filter present.

● Filter

Size	130(W) x 130(H) x 10(D) mm
------	----------------------------

■ Packing List

● Unit	1	● Filter	1
--------	---	----------	---

■ Replacement and Optional Parts

Part No.	Name/Description
A1001	Filter set/set of 5
C1568	Arm stand w/knobs(set of 2,ESD)
B1166	Knob/set of 2,ESD

HEAD OFFICE